

Coordinate System: UTM Zone 14N NAD83  
 Data Source: MB Hydro, ProvMB, NRCAN  
 Date Created: April 10, 2014  
 Version: Draft

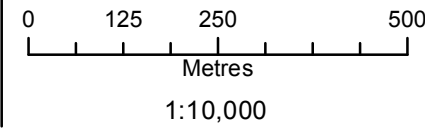

- Land Base**
- Transmission Line
  - Highway
  - Major Road
  - Local Road
  - Winter Road
  - Railway (Operational)
  - Railway (Discontinued)
  - First Nation
  - Mining
  - Provincial Forest

- Project Infrastructure**
- \* Angle Tower Locations
  - BPIII Final Preferred Route
  - 66 m Right of Way

- Points of Access\***
- Proposed Access Point
  - Major Stream Crossing
  - ▲ Abandoned Rail Crossing
  - ▲ Rail Crossing
  - Transmission Line Crossing
  - Proposed Access Route
- \*Labels correspond to BPIII Access Management Database

- ESS Features Resource Use**
- Food/Medicinal
  - Forestry

**Bipole III Transmission Project  
 Construction Environmental Protection Plan  
 Construction Section N4  
 Environmentally Sensitive Site Locations**

*Draft: For Discussion Purposes Only*

**ESS Group:** Forestry

Sec-Seg ID	ESS ID	ESS Name	Location	Start	Stop	UTM Zone	Distance
N4-S24	N4-Ruse-301	Shelterbelt	Site: 89 to 90	E-375396 N-5789174	E-375404 N-5789153	14N	23m

**Potential Effects:**

*Removal in area of ROW intersect*

**Specific Mitigation:**

- Carry out construction activities on frozen or dry ground to minimize surface damage, rutting and erosion
- Identify and flag prior to start of work
- Burn clearing debris during winter months only and ensure that all fires are extinguished prior to spring break-up
- Notify landowner regarding construction activities and schedule, and address concerns prior to start of work
- Where applicable, ensure compensation agreement is in place prior to start of work
- Use existing access trails, roads or cut lines whenever possible as access routes
- Limit all equipment to project footprint only, where possible

**ESS Group:** Food/Medicinal

Sec-Seg ID	ESS ID	ESS Name	Location	Start	Stop	UTM Zone	Distance
N4-S24	N4-Ruse-205	Plant Harvest	Site: 91 to 92	E-376190 N-5787177	E-378915 N-5780330	14N	7369 m

**Potential Effects:**

*Increased access for others and potential for conflict with trapline holders and current traditional users. Increased access by non-community members into culturally sensitive area.*

**Specific Mitigation:**

- Carry out construction activities on frozen or dry ground to minimize surface damage, rutting and erosion
- Minimize surface disturbance around the site to the extent possible
- Remove trees by low-disturbance methods
- No Herbicide to be applied during construction
- Confine vehicle traffic to established trails to the extent possible

MAP SHEET FULLY WITHIN THE N4-RUSE-205 FEATURE

N4-Ruse-205

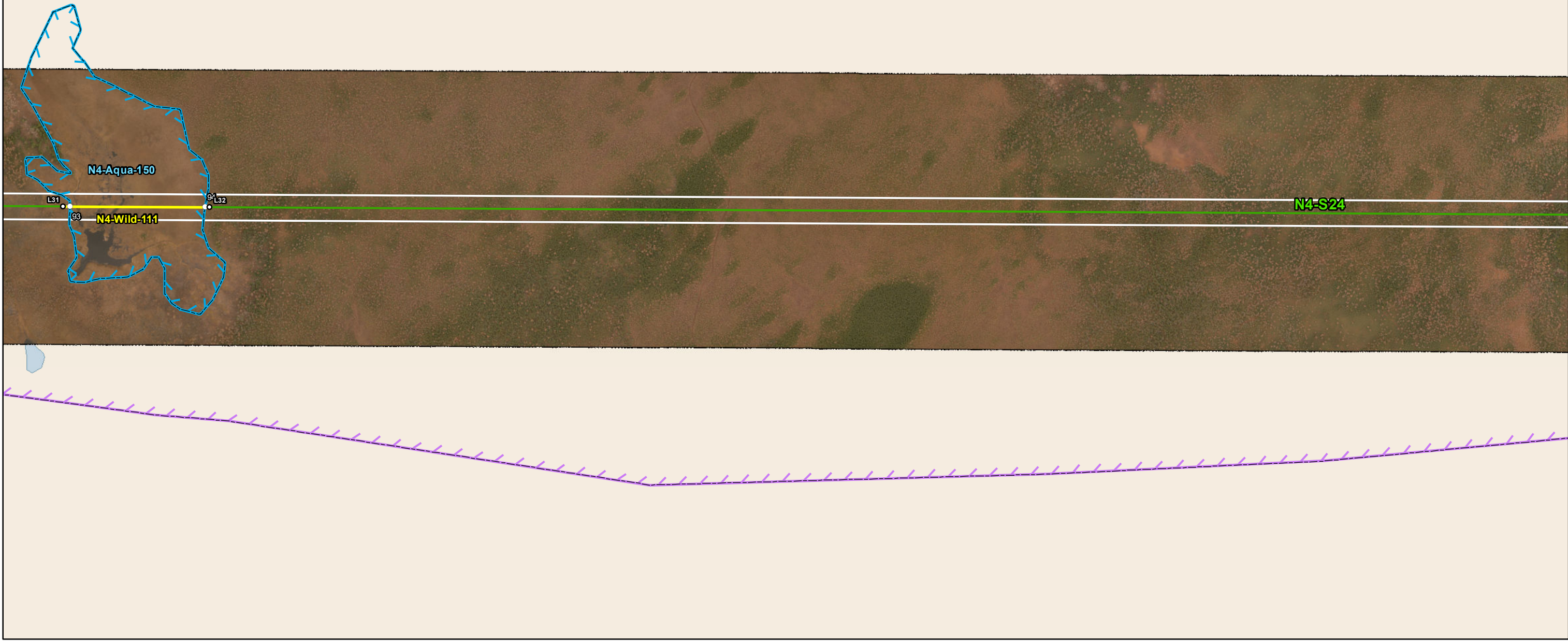

Coordinate System: UTM Zone 14N NAD83  
 Data Source: MB Hydro, ProvMB, NRCAN  
 Date Created: April 10, 2014  
 Version: Draft

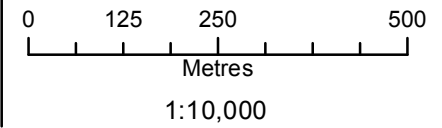

- Land Base**
- Transmission Line
  - Highway
  - Major Road
  - Local Road
  - Winter Road
  - Railway (Operational)
  - Railway (Discontinued)
  - First Nation
  - Mining
  - Provincial Forest

- Project Infrastructure**
- \* Angle Tower Locations
  - BPIII Final Preferred Route
  - 66 m Right of Way

- Points of Access\***
- Proposed Access Point
  - Major Stream Crossing
  - ▲ Abandoned Rail Crossing
  - ▲ Rail Crossing
  - Transmission Line Crossing
  - Proposed Access Route
- \*Labels correspond to BPIII Access Management Database

- ESS Features**
- Wildlife**
  - Birds and Habitat
  - Resource Use**
  - Food/Medicinal
  - Water**
  - Water Crossing

**Bipole III Transmission Project  
 Construction Environmental Protection Plan  
 Construction Section N4  
 Environmentally Sensitive Site Locations**

*Draft: For Discussion Purposes Only*

**ESS Group:** Birds and Habitat

Sec-Seg ID	ESS ID	ESS Name	Location	Start	Stop	UTM Zone	Distance
N2-S24	N4-Wild-114	Waterfowl sensitivity area	Site: L31 to L32	E-376755 N-5785759	E-376893 N-5785412	14N	372m

**Potential Effects:**

*Higher risk of wire collision, Risk of wire collision is localized to the right-of-way*

**Specific Mitigation:**

- Adhere to reduced risk timing windows for protection of birds (August 1- April 30)
- Maintain applicable setback during nesting and breeding timing window
- Conduct priority assessment for bird diverters and other measures prior to transmission line stringing
- Install bird diverters or other measures at high priority sites

**ESS Group:** Waterbody/ Riparian Buffer

Sec-Seg ID	ESS ID	ESS Name	Location	Start	Stop	UTM Zone	Distance
N4-S24	N4-Aqua-150	Unnamed pond	Site: 93 to 94	E-376761 N-5785744	E-376888 N-5785423	14N	345m

**Potential Effects:**

*Increased erosion and sedimentation; rutting of floodplains; loss of riparian vegetation*

**Specific Mitigation:**

- Riparian Buffer of 7m established surrounding the riparian zone, where all shrub and herbaceous vegetation will be retained and all trees that do not violate Manitoba Hydro vegetation clearance requirements will be retained

**ESS Group:** Food/Medicinal

Sec-Seg ID	ESS ID	ESS Name	Location	Start	Stop	UTM Zone	Distance
N4-S24	N4-Ruse-205	Plant Harvest	Site: 91 to 92	E-376190 N-5787177	E-378915 N-5780330	14N	7369 m

**Potential Effects:**

*Increased access for others and potential for conflict with trapline holders and current traditional users. Increased access by non-community members into culturally sensitive area.*

**Specific Mitigation:**

- Carry out construction activities on frozen or dry ground to minimize surface damage, rutting and erosion
- Minimize surface disturbance around the site to the extent possible
- Remove trees by low-disturbance methods
- No Herbicide to be applied during construction

- Confine vehicle traffic to established trails to the extent possible

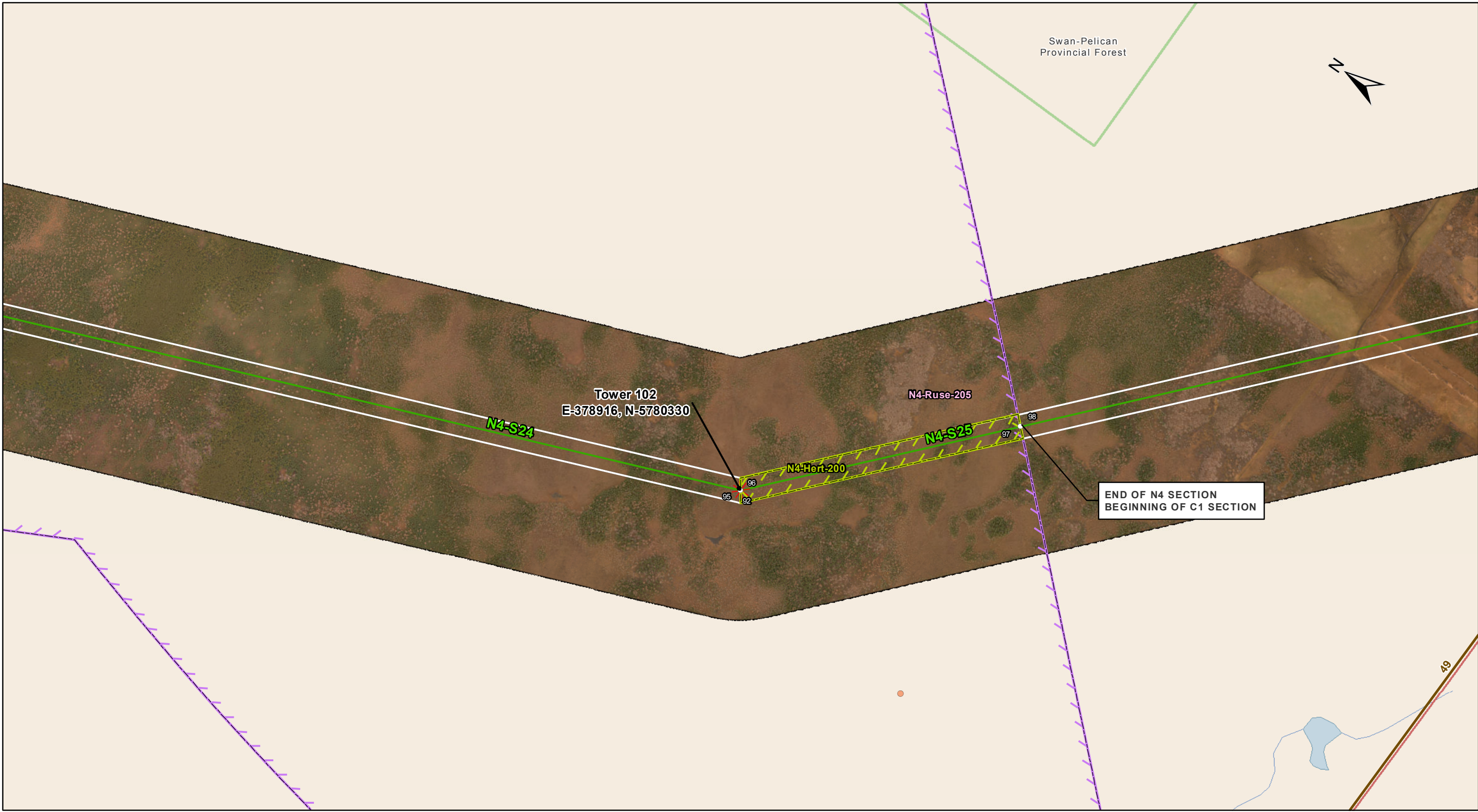

Coordinate System: UTM Zone 14N NAD83  
 Data Source: MB Hydro, ProvMB, NRCAN  
 Date Created: April 10, 2014  
 Version: Draft

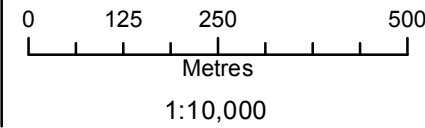

- Land Base**
- Transmission Line
  - Highway
  - Major Road
  - Local Road
  - Winter Road
  - Railway (Operational)
  - Railway (Discontinued)
  - First Nation
  - Mining
  - Provincial Forest

- Project Infrastructure**
- \* Angle Tower Locations
  - BPiII Final Preferred Route
  - 66 m Right of Way

- Points of Access\***
- Proposed Access Point
  - Major Stream Crossing
  - ▲ Abandoned Rail Crossing
  - ▲ Rail Crossing
  - Transmission Line Crossing
  - Proposed Access Route
- \*Labels correspond to BPiII Access Management Database

- ESS Features**
- Resource Use**
- Food/Medicinal
- Heritage**
- Cultural
- Resource Use**
- Food/Medicinal

**Bipole III Transmission Project  
 Construction Environmental Protection Plan  
 Construction Section N4  
 Environmentally Sensitive Site Locations**

*Draft: For Discussion Purposes Only*

**ESS Group:** Cultural

Sec-Seg ID	ESS ID	ESS Name	Location	Start	Stop	UTM Zone	Distance
N4-S24	N4-Ruse-205	Plant Harvest	Site: 91 to 92	E-376190 N-5787177	E-378915 N-5780330	14N	7369 m
N4-S25	N4-Ruse-205	Plant Harvest	Site: 95 to 98	E-378915 N-5780330	E-379493 N-5779807	14N	779 m
N4-S25	N4-Hert-200	Gathering Area	Site: 96 to 97	E-378915 N-5780330	E-379493 N-5779807	14N	778 m

**Potential Effects:**

*Increased access for others and potential for conflict with trapline holders and current traditional users. Increased access by non-community members into culturally sensitive area.*

**Specific Mitigation:**

- Carry out construction activities on frozen or dry ground to minimize surface damage, rutting and erosion
- Minimize surface disturbance around the site to the extent possible
- Remove trees by low-disturbance methods
- No Herbicide to be applied during construction
- Confine vehicle traffic to established trails to the extent possible